

# A47 Wansford to Sutton Dualling

**Scheme Number: TR010039**

## **Volume 2** **2.1 Location Plan**

APFP Regulation 5(2)(o)

Planning Act 2008

Infrastructure Planning (Applications: Prescribed  
Forms and Procedure) Regulations 2009

February 2022

Deadline 2

Infrastructure Planning

Planning Act 2008

**The Infrastructure Planning  
(Applications: Prescribed Forms and  
Procedure) Regulations 2009**

The A47 Wansford to Sutton Dualling  
Development Consent Order 202[x]

---

**2.1 Location Plan**

---

|   |   |
|---|---|
| <b>Regulation Number:</b>                     | Regulation 5(2)(o)  |
| <b>Planning Inspectorate Scheme Reference</b> | TR010039  |
| <b>Application Document Reference</b>         | TR010039/APP/2.1  |
| <b>Author:</b>                                | A47 Wansford to Sutton<br>Project Team, National Highways |

| <b>Version</b> | <b>Date</b>   | <b>Status of Version</b> |
|----------------|---------------|--------------------------|
| Rev 0          | June 2021     | Application Issue        |
| Rev 1          | February 2022 | Deadline 2               |

## CONTENTS

|          |  |          |
|----------|--|----------|
| <b>1</b> | <b>INTRODUCTION.....</b>   | <b>1</b> |
| 1.1      | Purpose of this Document.....  | 1        |
| <b>2</b> | <b>SCHEDULE OF PLANS INCLUDED IN THIS APPLICATION DOCUMENT .....</b> | <b>2</b> |

## 1 INTRODUCTION

### 1.1 Purpose of this Document

- 1.1.1 This Location Plan (this “Plan”) relates to an application made by Highways England (the “Applicant”) to the Secretary of State for Transport, via the Planning Inspectorate (the “Inspectorate”) under the Planning Act 2008 (the “2008 Act”) for a Development Consent Order (DCO). If made, the DCO would grant consent for the A47 Wansford to Sutton Scheme (the “Scheme”).
- 1.1.2 The Scheme comprises the alteration of an existing highway by way of an upgrade to an existing 2.5km of single carriageway between Wansford and Sutton. It will include building a new dual carriageway, partly to the north and also to the south of the existing A47 plus a free flow link from the A1 southbound’ improving traffic flow and reducing congestion on the route. A detailed description of the Scheme can be found in Chapter 2: The Proposed Scheme of the Environmental Statement (ES) (**TR010039/APP/6.1**). This Plan covers the Scheme in its entirety.
- 1.1.3 The Location Plan comprises part of a suite of application documentation and is included in the application in compliance with Regulation 5(2)(o) of the Infrastructure Planning (Applications: Prescribed Forms and Procedure) Regulations 2009 (the “2009 Regulations”) which requires:
- 5(2)(o) “... any other plans, drawings and sections necessary to describe the proposals for which development consent is being sought, showing details of design, external appearance and the preferred layout of buildings or structures, drainage, surface water management, means of vehicular and pedestrian access, any car parking to be provided, and means of landscaping”.*
- 1.1.4 Although Regulation 5(2)(o) does not expressly mention location, the Inspectorate’s Advice Note Six: Preparation and submission of application documents (February 2016: Version 7) suggests (at Appendix 1) that an application for development consent may include the submission of a location plan.
- 1.1.5 This Plan therefore has been included in the application to identify the location of the Scheme in its wider geographical context. As a consequence, the Plan uses a smaller scale than that prescribed in Regulation 5(3) of the 2009 Regulations but only so the wider geographical context can be represented on a single sheet plan.
- 1.1.6 As the Plan is part of the application documents, it should be read alongside and is informed by the other application documents.

## 2 SCHEDULE OF PLANS INCLUDED IN THIS APPLICATION DOCUMENT

| Drawing Title                      | DCO Document Number    | Drawing Number                   | Revision |
|------------------------------------|------------------------|----------------------------------|----------|
| Location Plan – Regulation 5(2)(o) | TR010039/APP/2.1 Rev 1 | HE551490-GTY-HGN-000-DR-CH-38001 | P02      |

This drawing should not be relied on or used in circumstances other than those for which it was originally prepared and for which Sweco UK Ltd was commissioned. Sweco UK Ltd accepts no responsibility for this drawing to any party other than the person by whom it was commissioned. This drawing has been prepared on behalf of Galliford Try by Sweco UK Ltd for the titled project or named part thereof and should not be relied upon or used for any other project without an independent check being carried out as to its suitability and prior written authority of Galliford Try being obtained. Sweco UK Ltd accepts no responsibility or liability for the consequences of this drawing being used for a purpose other than the purposes for which it was commissioned. Any person using or relying on this drawing for such other purpose agrees, and will by such use or reliance be taken to confirm his/her agreement, to indemnify Sweco UK Ltd for all loss or damage resulting therefrom.

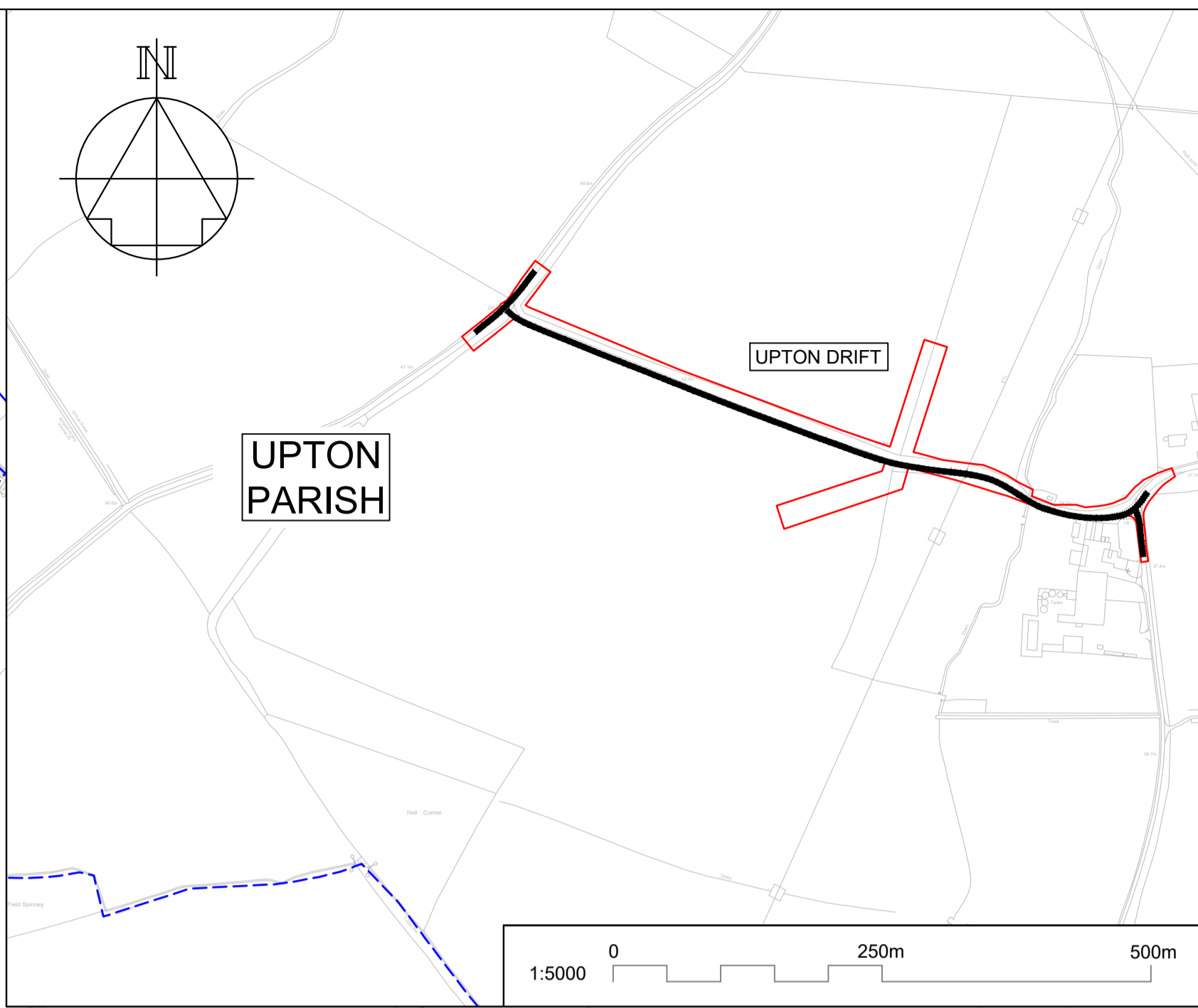
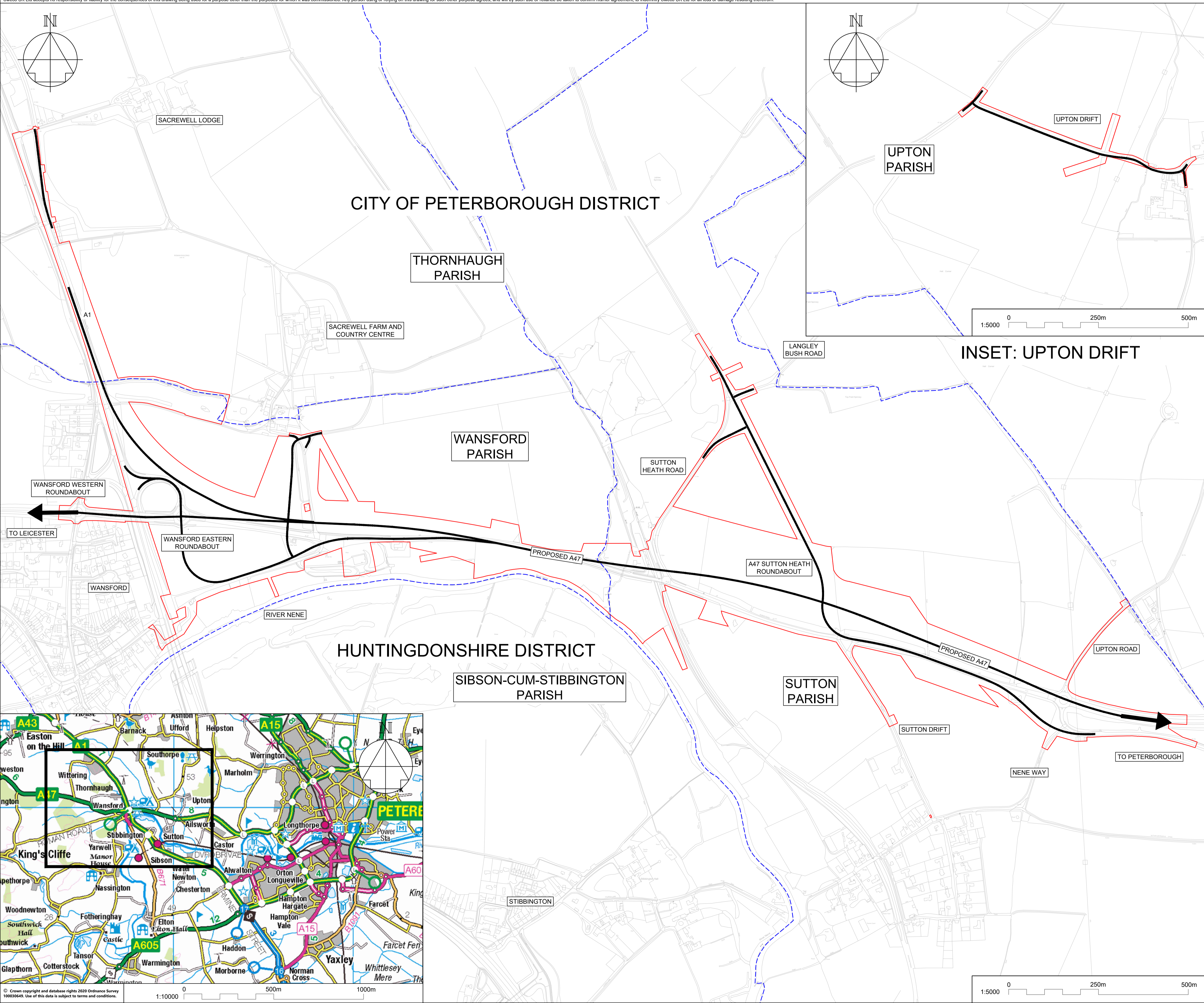

| <b>NOTES</b>   |  |                                   |          |      |      |               |     |      |      |     |          |           |      |      |     |     |          |                                   |    |    |      |
|--|--|-----------------------------------|----------|------|------|---------------|-----|------|------|-----|----------|-----------|------|------|-----|-----|----------|-----------------------------------|----|----|------|
| Purpose of use   |  |                                   |          |      |      |               |     |      |      |     |          |           |      |      |     |     |          |                                   |    |    |      |
| <b>FOR DCO SUBMISSION</b>  |  |                                   |          |      |      |               |     |      |      |     |          |           |      |      |     |     |          |                                   |    |    |      |
| Development Consent Order Number / Document  |  |                                   |          |      |      |               |     |      |      |     |          |           |      |      |     |     |          |                                   |    |    |      |
| TR010039/APP/2.1   |  |                                   |          |      |      |               |     |      |      |     |          |           |      |      |     |     |          |                                   |    |    |      |
| <b>KEY:</b>  |  |                                   |          |      |      |               |     |      |      |     |          |           |      |      |     |     |          |                                   |    |    |      |
|  | ORDER LIMITS   |                                   |          |      |      |               |     |      |      |     |          |           |      |      |     |     |          |                                   |    |    |      |
|  | A47 WANSFORD TO SUTTON DUALLING SCHEME (INCLUDES MAINLINE AND SIDEROAD ALIGNMENTS) |                                   |          |      |      |               |     |      |      |     |          |           |      |      |     |     |          |                                   |    |    |      |
|  | COUNCIL & PARISH BOUNDARIES  |                                   |          |      |      |               |     |      |      |     |          |           |      |      |     |     |          |                                   |    |    |      |
| 1. THIS DRAWING SHOULD BE READ IN CONJUNCTION WITH ALL PLANS AND DOCUMENTS INCLUDED IN THE DCO APPLICATION.  |  |                                   |          |      |      |               |     |      |      |     |          |           |      |      |     |     |          |                                   |    |    |      |
| 2. BASE MAP REPRODUCED FROM ORDINANCE SURVEY MAPPING.  |  |                                   |          |      |      |               |     |      |      |     |          |           |      |      |     |     |          |                                   |    |    |      |
| 3. THIS PLAN IS SUBMITTED TO IDENTIFY THE LOCATION OF THE PROJECT AT A WIDER SCALE. IT IS NOT REQUIRED TO BE SUBMITTED UNDER REGULATIONS 5(2) OF THE INFRASTRUCTURE PLANNING (APPLICATIONS: PRESCRIBED FORMS & PROCEDURES) REGULATIONS 2009, SO IS PRESENTED AT A SMALLER SCALE THAN 1:2500  |  |                                   |          |      |      |               |     |      |      |     |          |           |      |      |     |     |          |                                   |    |    |      |
| <b>SHEET PLAN</b>  |  |                                   |          |      |      |               |     |      |      |     |          |           |      |      |     |     |          |                                   |    |    |      |
|  |  |                                   |          |      |      |               |     |      |      |     |          |           |      |      |     |     |          |                                   |    |    |      |
| <table border="1"> <thead> <tr> <th>REV</th> <th>DATE</th> <th>REVISION NOTE</th> <th>ORG</th> <th>CHKD</th> <th>APPD</th> </tr> </thead> <tbody> <tr> <td>P01</td> <td>28/07/21</td> <td>DCO ISSUE</td> <td>CDye</td> <td>AWoo</td> <td>SCM</td> </tr> <tr> <td>P02</td> <td>11/02/22</td> <td>PLAN AREA MOVED TO SHOW SE CORNER</td> <td>RO</td> <td>PE</td> <td>MMur</td> </tr> </tbody> </table> |  |                                   |          | REV  | DATE | REVISION NOTE | ORG | CHKD | APPD | P01 | 28/07/21 | DCO ISSUE | CDye | AWoo | SCM | P02 | 11/02/22 | PLAN AREA MOVED TO SHOW SE CORNER | RO | PE | MMur |
| REV  | DATE   | REVISION NOTE                     | ORG      | CHKD | APPD |               |     |      |      |     |          |           |      |      |     |     |          |                                   |    |    |      |
| P01  | 28/07/21   | DCO ISSUE                         | CDye     | AWoo | SCM  |               |     |      |      |     |          |           |      |      |     |     |          |                                   |    |    |      |
| P02  | 11/02/22   | PLAN AREA MOVED TO SHOW SE CORNER | RO       | PE   | MMur |               |     |      |      |     |          |           |      |      |     |     |          |                                   |    |    |      |
| DESIGNER   |  |                                   |          |      |      |               |     |      |      |     |          |           |      |      |     |     |          |                                   |    |    |      |
|  |  |                                   |          |      |      |               |     |      |      |     |          |           |      |      |     |     |          |                                   |    |    |      |
| CONTRACTOR   |  |                                   |          |      |      |               |     |      |      |     |          |           |      |      |     |     |          |                                   |    |    |      |
|  |  |                                   |          |      |      |               |     |      |      |     |          |           |      |      |     |     |          |                                   |    |    |      |
| CLIENT   |  |                                   |          |      |      |               |     |      |      |     |          |           |      |      |     |     |          |                                   |    |    |      |
|  |  |                                   |          |      |      |               |     |      |      |     |          |           |      |      |     |     |          |                                   |    |    |      |
| PROJECT TITLE  |  |                                   |          |      |      |               |     |      |      |     |          |           |      |      |     |     |          |                                   |    |    |      |
| A47 WANSFORD TO SUTTON DUALLING  |  |                                   |          |      |      |               |     |      |      |     |          |           |      |      |     |     |          |                                   |    |    |      |
| PROJECT STAGE  |  |                                   |          |      |      |               |     |      |      |     |          |           |      |      |     |     |          |                                   |    |    |      |
| PCF STAGE 4  |  |                                   |          |      |      |               |     |      |      |     |          |           |      |      |     |     |          |                                   |    |    |      |
| DRAWING TITLE  |  |                                   |          |      |      |               |     |      |      |     |          |           |      |      |     |     |          |                                   |    |    |      |
| LOCATION PLAN<br>REGULATION 5(2)(o)  |  |                                   |          |      |      |               |     |      |      |     |          |           |      |      |     |     |          |                                   |    |    |      |
| SUITABILITY  |  |                                   |          |      |      |               |     |      |      |     |          |           |      |      |     |     |          |                                   |    |    |      |
| SUITABLE FOR INFORMATION   |  |                                   |          |      |      |               |     |      |      |     |          |           |      |      |     |     |          |                                   |    |    |      |
| SHEET SIZE   | SCALE  | STATUS                            | REVISION |      |      |               |     |      |      |     |          |           |      |      |     |     |          |                                   |    |    |      |
| A1   | AS SHOWN   | S2                                | P02      |      |      |               |     |      |      |     |          |           |      |      |     |     |          |                                   |    |    |      |
| DRAWING NUMBER   |  |                                   |          |      |      |               |     |      |      |     |          |           |      |      |     |     |          |                                   |    |    |      |
| HE551494-GTY-HGN-000-DR-CH-38001   |  |                                   |          |      |      |               |     |      |      |     |          |           |      |      |     |     |          |                                   |    |    |      |

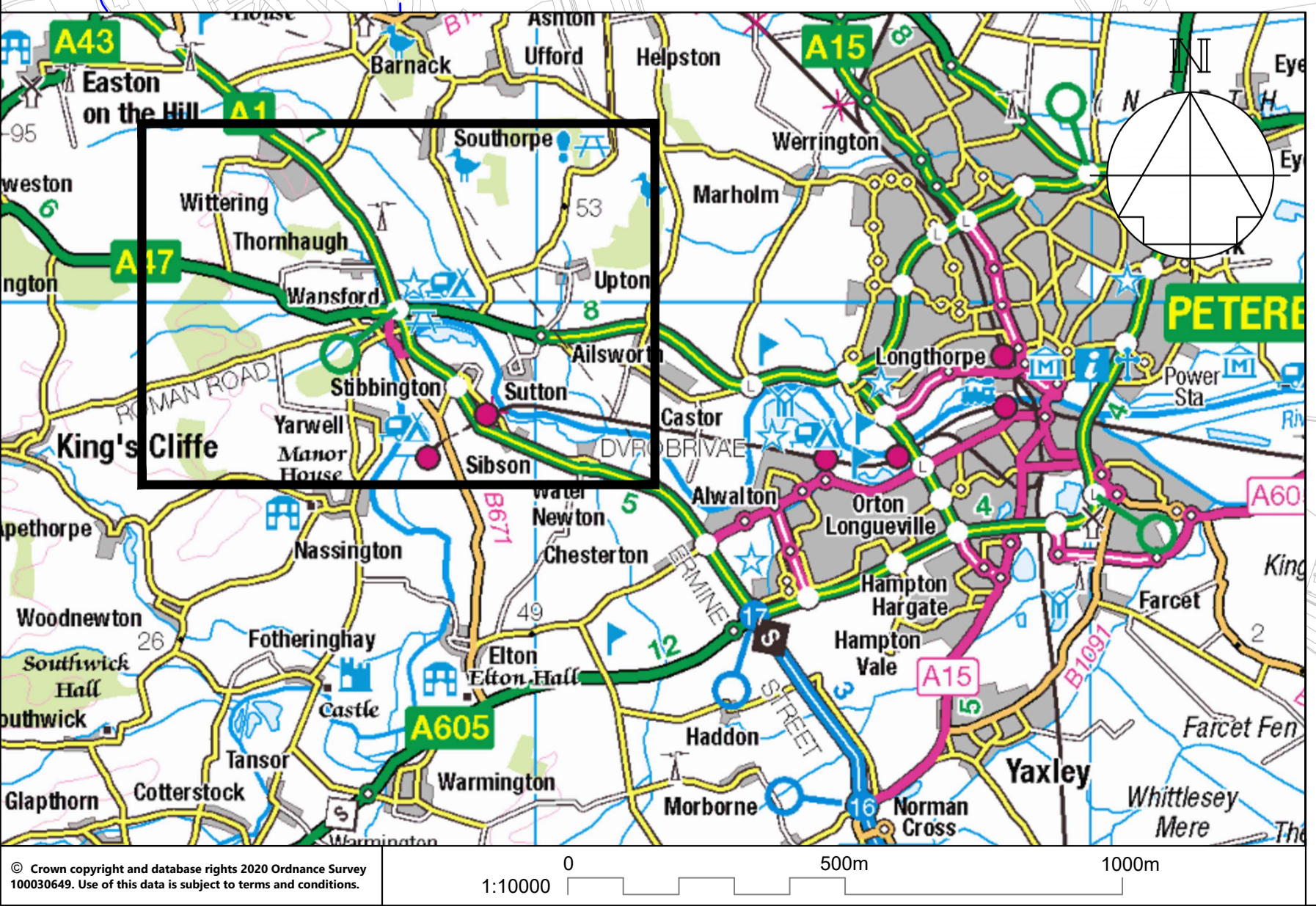

© Crown copyright and database rights 2020 Ordnance Survey 10003645. Use of this data is subject to terms and conditions.